

SCHOOL DISTRICT OF PALM BEACH COUNTY
ELEMENTARY CLASSROOM PROTOTYPE PreK-2 Activity Centers
FLOOR PLAN @ 900 S.F.

OCTOBER, 2005

SYMBOLS LEGEND

- ⊕ DUPLEX
- ⊕ DEDICATED DUPLEX
- ⊕ QUADRAPLEX
- ◀ TELEPHONE/DATA
- ◀ DEDICATED DATA OUTLET
- ⊙ CALL BUTTON
- ▶ HORN/STROBE
- ▶ SECURITY MONITOR
- MC MULTI-MEDIA CABINET OUTLETS (SEE BLDG. DEPT. DETAIL)
- - DENOTES N.I.C. FURNITURE & EQUIP
- DENOTES CONTRACTOR PROVIDED MILLWORK

NOTES

KINDERGARTEN WILL VARY W/ADD'L DOORS TO OUTSIDE PLAY AREA & SHARED KITCHEN

INTERMEDIATE WILL VARY W/RESTROOM CONFIGURATION

ALL LOCKS KEYED ALIKE

CSR RATIOS (CLASS SIZE REDUCTION)
 Pre-K - 3 = 1:18
 4 - 5 = 1:22

900 S.F. CLASSROOM
 45 S.F. STORAGE
 40 S.F. RESTROOM

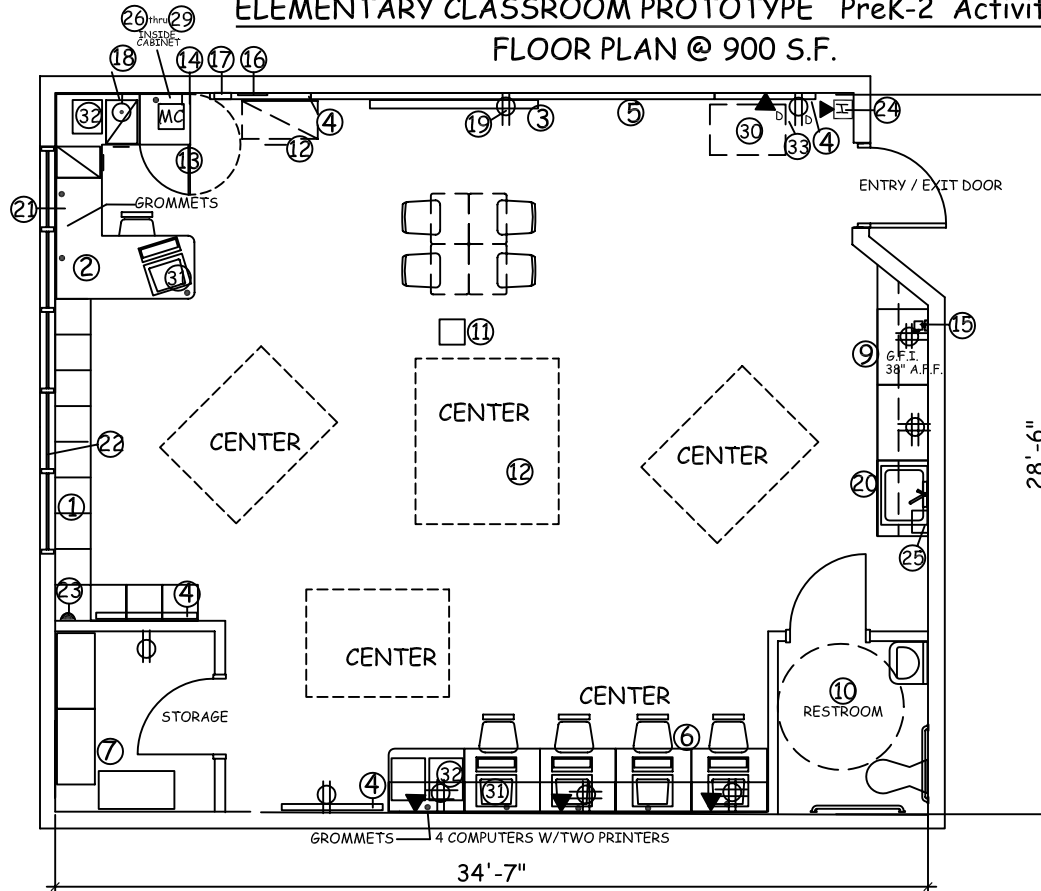

LEGEND

- ① BUILT-IN CUBBY HOLES
- ② BUILT-IN WORKSTATION (w/2 LOCKABLE PEDESTALS)
- ③ PROJECTION SCREEN LOCATION
- ④ TACK BOARD
- ⑤ MARKERBOARD W/MAP RAIL & CHALK RAIL
- ⑥ BUILT-IN COMPUTER COUNTER
- ⑦ METAL SHELVING 36W X 18D X 80H
- ⑧ NOT USED
- ⑨ BUILT-IN UPPERS & LOWERS W/SINK (LOCKABLE)
- ⑩ RESTROOM PER CODE
- ⑪ LCD PROJECTOR (BY OWNER)
- ⑫ DASHED DENOTES (NIC) FURNITURE
- ⑬ BUILT-IN MULTI-MEDIA CAB. (LOCKABLE)
- ⑭ MULTI-MEDIA OUTLETS (SEE BLDG. DEPT. DETAIL)
- ⑮ ELECTRIC PENCIL SHARPENER
- ⑯ GPS CLOCK LOCATION
- ⑰ P.A. SPEAKER
- ⑱ TEACHER CALL BUTTON
- ⑲ TYP. POWER/DATA OUTLETS (SEE SYMBOLS LEGEND)
- ⑳ PANEL TO CONCEAL PLUMBING
- ㉑ TEACHER STATION OUTLETS (SEE BLDG. DEPT. DETAIL)
- ㉒ WINDOWS W/VERTICAL BLINDS
- ㉓ SECURITY MONITOR
- ㉔ HORN/STROBE
- ㉕ PAPER TOWEL DISPENSAR
- ㉖ DVD/VCR COMBO UNIT (BY OWNER)
- ㉗ SOUND FIELD ENHANCEMENT (BY OWNER)
- ㉘ ITV/FUTURE EQUIPMENT (BY OWNER)
- ㉙ DOCUMENT CAMERA (BY OWNER)
- ㉚ WIRELESS LAPTOP CART (FUTURE-BY OWNER)
- ㉛ COMPUTERS (BY OWNER)
- ㉜ PRINTERS/SCANNER (BY OWNER)
- ㉝ DEDICATED POWER/DATA OUTLETS